

2007

WIND ENERGY INSTITUTE

*Presented by The University of Texas School of Law, The Oil, Gas and Energy Resources Law Section
of the State Bar of Texas, and The Wind Coalition*

Earn up to 13.25 Hours of MCLE Credit
Specialization Credit Expected for Oil, Gas & Mineral Law



February 26 - 27, 2007

Austin Convention Center • Austin, Texas

PLATINUM SPONSORS

FPL ENERGY, LLC • RES AMERICAS

GOLD SPONSORS

AES WIND GENERATION • AIRTRICITY, INC. • DIRECT ENERGY, LP

SILVER SPONSORS

BAKER BOTTS L.L.P. • INVENERGY LLC • GEXA ENERGY

McELROY, SULLIVAN & MILLER L.L.P. • MORGAN LEWIS & BOCKIUS LLP

SIEMENS WIND POWER • STEAKLEY, WETSEL & CARMICHAEL, L.L.P.

STOEL RIVES LLP • VESTAS AMERICAS • VINSON & ELKINS LLP

2007

WIND ENERGY INSTITUTE

Presented by The University of Texas School of Law, The Oil, Gas and Energy Resources Law Section of the State Bar of Texas, and The Wind Coalition

February 26 - 27, 2007 • Austin Convention Center • Austin, Texas

Earn up to 13.25 Hours of MCLE Credit

MONDAY, FEBRUARY 26, 2007

Presiding Officer: Lisa Chavarria, McElroy, Sullivan & Miller, L.L.P., Austin, TX

8:00 a.m. Registration Opens

Includes continental breakfast.

8:50 a.m. Welcoming Remarks

9:00 a.m. 1.00 hr

A Primer on Wind Energy: Meteorology, Technology, Economics and Transmission

A substantial portion of this session is dedicated to the meteorology of wind and wind siting; with brief overviews of technology, economics and transmission issues that will be discussed in more detail throughout the conference.

Dr. Jaime Chapman, Texas Tech Wind Energy Center, Lubbock, TX

Andrew Swift, Texas Tech Wind Energy Center, Lubbock, TX

10:00 a.m. 1.00 hr

All About Wind Turbines: Supply, Demand, Regulation, Innovations and the Impact on Future Development

Leading wind turbine manufacturers discuss the state of the turbine market: supply, demand, trends, specialization between manufacturers, and the impact of technical innovation and higher efficiencies on the size, scope and location of future development.

Moderator: Adam S. Umanoff, Morgan, Lewis and Bockius LLP, Los Angeles, CA

Sean Fitzgerald, GE Infra, Energy, Saratoga Springs, NY

Chris A. Lambert, Mitsubishi Power Systems Americas, Newport Beach, CA

Dany St-Pierre, Siemens Wind Power, Orlando, FL

Geoff Sharples, Clipper Windpower Inc., Carpinteria, CA

Stephen Wieland, Vestas Americas, Denver, CO

11:00 a.m. Break

11:15 a.m. .50 hr

Wind Development: Key Survey and Title Issues

A discussion of key survey and title issues in wind energy project developments. Title review checklists, survey review checklists, and sample survey certification language will be provided, along with sample forms to resolve commonly encountered title and survey problems. Practical suggestions will also be offered on how to coordinate landowner and title company due diligence as well as the format and review of surveys and title commitments in instances in which numerous landowners and tracts are involved.

Kimberlee Centera, AES Wind Generation, San Diego, CA

Brent G. Stahl, Stahl, Bernal & Davies, L.L.P., Austin, TX

11:45 a.m. .67 hr

Anatomy of a Wind Deal

A non-technical discussion of the role and impact of federal tax credit, state renewable energy credits, turbine deposits, interconnection agreements and other related economic consideration in wind deals—an overview of the key issues covered in the developers' roundtable to follow.

Ciaran O'Brien, Airtricity, Inc., Chicago, IL

12:25 p.m. Lunch On Your Own

MONDAY AFTERNOON

Presiding Officer: Andy Bowman, Airtricity, Inc., Austin, TX

1:30 p.m. 1.00 hr

Wind Leases: Developer and Land Owner Perspectives

This session covers the latest developments and emerging terms in wind leases and the key negotiating points between developers and landowners. Sample leases and annotated clauses will be provided.

Moderator: Heather Offen, Invenergy LLC, Austin, TX

Lisa Chavarria, McElroy, Sullivan & Miller, L.L.P., Austin, TX

Roderick E. Wetsel, Steakley, Wetsel & Carmichael, L.L.P., Sweetwater, TX

Robert P. Wright, Baker Botts L.L.P., Houston, TX

2:30 p.m. 1.25 hr

Developers' Roundtable: Wind Deals in Texas

This session examines how developers look at the viability and value of potential projects, including key legal and financial considerations.

Moderator: Ward C. Marshall, Babcock & Brown, Austin, TX and San Francisco, CA

Andy Bowman, Airtricity, Inc., Austin, TX

Dave Herrick, FPL Energy, LLC, Juno Beach, FL

Craig Matakynski, RES Americas, Austin, TX

Robert Sims, AES Wind Generation, San Diego, CA

Wayne Walker, Horizon Wind Energy, Houston, TX

Stephen Wiley, Gamesa Energy USA, Austin, TX

3:45 p.m. Break

4:00 p.m. 1.00 hr

Follow the Money: The Rush to Finance and Invest in Renewables

This session examines who's investing in wind deals and the nature and characteristics of investing and finance at each stage in development. Learn who the major players and financiers are and what they are looking for—business and legal considerations. This session will also discuss the M&A activity in this section and implications for the industry.

Moderator: Douglas S. Bland, Vinson & Elkins, Houston, TX

William H. Holmes, Stoel Rives LLP, Portland, OR

Stephen Krebs, Baker Botts L.L.P., Houston, TX

Kevin B. Smith, Invenergy LLC, Chicago, IL

BP Alternative Energy North America Representative TBA

5:00 p.m. Film

Texas Wind Farms: A Tour from Turbines to Market

This short documentary—produced specifically for the 2007 Conference—takes you onto working wind farms in the Sweetwater, TX region: from ground operations to the top of the turbines, to explain construction, generation, operation, and interconnection. As a special bonus, each attendee will receive a complimentary DVD of the documentary.

Many thanks to Babcock & Brown, FPL Energy, LLC, GE Wind Energy, and the Sweetwater community.

5:20 p.m. Adjourn to Reception
Many thanks to our Gold sponsors:
AES Wind Generation
Airtricity, Inc.
Direct Energy, LP

TUESDAY, FEBRUARY 27, 2007

Presiding Officer: Mike Sloan, Virtus Energy Research Associates, Inc., Austin, TX

9:00 a.m. .75 hr

Grid 101: Understanding the Electrical Transmission Grid in Texas

The essential primer on the power system, including the fundamentals on managing the grid, transmission constraints, reliability limits and capacity issues, key terms, vocabulary and concepts—all with PowerPoint illustrations.

Ken Donohoo, ERCOT, Taylor, TX

9:45 a.m. .75 hr

From Economics to Clean Air Credits: Is Wind Power a Good Deal for Texas?

This session opens with a brief explanation of the role and operation of the Texas Renewable Portfolio Standards (RPS) and Renewable Energy Credits (REC), and continues with a discussion of related policy issues, e.g., transmission funding, wind integration issues, new emission credits, etc. The panel closes with an exchange of differing views on the economics and environmental impact of wind energy and what is the best wind policy for Texas' future.

Mark Dreyfus, Austin Energy, Austin, TX
Phillip G. Oldham, Andrews Kurth LLP, Austin, TX
Mike Sloan, Virtus Energy Research Associates, Inc., Austin, TX

10:30 a.m. Break

10:45 a.m. 1.25 hr

Grid 102: The Future of Transmission in Texas

The future growth and location of wind developments are heavily dependent on transmission capacity to move energy from wind farms in largely rural wind areas to more densely populated markets. The transmission for many wind-rich areas of Texas is near or at capacity, and will be subject to transmission curtailment by ERCOT, if additional wind farms are developed. The Texas Legislature has taken steps to increase the contribution of renewable energy resources by asking ERCOT to study and the PUC to designate Competitive Renewable Energy Zones (CREZ) and identify the new transmission facilities needed for the CREZs.

In December 2006, ERCOT provided the PUC with engineering analysis for new CREZ zones' designations: Which areas are most likely to be designated and see build-out, on which routes, at what capacity levels, and when? What will the impact be on transmission capacity, and the location of

new wind power development? How will transmission build-out be prioritized, financed and actually constructed? What impact will ERCOT's new nodal pricing mechanisms have on development incentives? Leading experts from ERCOT, the PUC and the transmission sector will explain the new system, and discuss how these new rules are likely to play out in practice over the next year.

Ken Donohoo, ERCOT, Taylor, TX
Paul Hassink, AEP, Tulsa, OK
Jess Toffen, PUC, Austin, TX
Dan Woodfin, ERCOT, Taylor, TX

LUNCHEON PRESENTATION

Many thanks to our Platinum sponsors:
FPL Energy, LLC
RES Americas

12:00 p.m. Pick Up Box Lunch
Included in conference registration fee.

12:15 p.m.

Welcoming Remarks: Wind Energy in Texas

Phil Wilson, Deputy Chief of Staff, Office of the Governor

12:30 p.m. 1.25 hr

Wind Energy Policymaker Panel: Where We've Been and Where We're Going

Leading policymakers look back at the recent SB20 legislation and discuss the state of pending regulations and future policy initiatives designed to promote the growth of wind power.

Moderator: Paul Hudson, PUC, Austin, TX
Senator Troy Fraser, Marble Falls (invited)
Representative Phil King, Weatherford, TX
Jerry Patterson, Commissioner, Texas General Land Office, Austin, TX
Representative David Swinford, Amarillo, TX
Kathleen Harnett White, Chairman, TCEQ, Austin, TX

TUESDAY AFTERNOON

Presiding Officer: C. Kingsbery Otto, Attorney, Austin, TX

2:00 p.m. .75 hr

Coastal and Offshore Wind Development

This session discusses unique siting; development and technical issues relative to coastal and offshore development; special leasing and other regulatory issues; and concludes with a discussion on how long it will take for offshore development to be operational in Texas.

Moderator: M. Bradford Moody, Watt, Beckworth & Thompson, L.L.P., Houston, TX
Patrick A. Nye, American Shoreline, Inc., Corpus Christi, TX
Jorge Ramirez, Texas General Land Office, Austin, TX
Tom "Smitty" Smith, Public Citizen, Austin, TX

2:45 p.m. 1.25 hr

The Market for Wind Energy: Who's Buying, Who's Not, and Why

Market-based consumer demand for cleaner energy sources represents a major drive for future wind power installations. Whether through direct energy purchases or renewable energy credits, many environmentally-sensitive corporate and individual consumers are rapidly creating demand while a variety of players from traditional energy companies to brand new ventures are readying to serve that demand. This session discusses the motivations, possible regulatory obstacles, strategy and goals of various market participants—with a look at likely trends and developments over the next few years.

Moderator: Matt Clouse, Green Power Partnership, EPA, Washington D.C.

Chris Hendrix, Texas Retail Energy (Wal-Mart), Bentonville, AR

Phillip W. Tonge, Direct Energy, LP, Houston, TX

TJ Tuscai, Gexa Energy, Houston, TX

Wells Fargo Representative TBA

4:00 p.m. .50 hr

Local and County Perspectives (and Pitfalls) in Dealing with Wind Energy

A discussion of the impact of wind farm development at the (mostly rural) local and county levels. Construction, landowner royalties, spending, changes in the tax base and negotiations, and implementation of tax abatements—hear from those who have been through the process and have advised local officials or assisted developers on wind developments.

Charles L. Black, Wagstaff, Alvis, Stubbeman, Seamster & Longacre, L.L.P., Abilene, TX

Hon. Mitchell G. Davenport, Jack County, Jacksboro, TX

C. Kingsbery Otto, Attorney, Austin, TX

4:30 p.m. .50 hr

Getting Off the Grid: Distributed Generation and Small Scale Self-Generation

Want to go green? Get off the grid? Stay on the grid but reduce your energy bill? A former regulator and manufacturers of small scale wind turbines discuss what's involved and how it works.

Mike Bergey, Bergey WindPower, Norman, OK
Mike Grable, ERCOT, Austin, TX
Andy Kruse, Southwest Windpower, Flagstaff, AZ

5:00 p.m. Adjourn

Texas Wind Farms Movie and DVD
Included in conference registration!

PLATINUM SPONSORS

FPL Energy, LLC



Florida Power & Light Company is the principal subsidiary of FPL Group, Inc. (NYSE: FPL), nationally known as a high quality, efficient and customer-driven organization focused on energy-related products and services. With annual revenues of more than \$11 billion and a growing presence in 26 states, FPL Group is widely recognized as one of the country's premier power companies. Florida Power & Light Company serves 4.4 million customer accounts in Florida. FPL Energy, LLC, FPL Group's competitive energy subsidiary, is a leader in producing electricity from clean and renewable fuels. www.FPL.com

RES Americas



Renewable Energy Systems (RES) is one of the fastest growing wind development companies in the world and has been at the forefront of the wind industry since it was founded in 1981. RES has been active in North America since 1997 and during this time has either developed or constructed over 10% of the installed capacity in the United States. RES has offices in Austin Texas, Portland Oregon, Minneapolis MN, and Montreal Quebec. www.res-americas.com

GOLD SPONSORS

AES Wind Generation



AES is one of the world's largest global power companies, with operations in 26 countries, and five continents, our 122 generation facilities have the capacity to generate over 44,000 megawatts and serve 100 million people worldwide. Our global workforce of 30,000 people is committed to operational excellence and meeting the world's growing power needs. www.aes.com

Airtricity, Inc.



Airtricity is a world leading renewable energy company, developing and operating wind farms in the United States, Canada and Europe. The company constructed its first projects in Texas during 2006 and will have more than 500 megawatts of wind projects on-line in Texas by 2007. www.airtricity.com

Direct Energy, LP



Direct Energy is the third largest retail energy provider in the state and serves residential and commercial customers through the Direct Energy, CPL Retail Energy and WTU Retail Energy brands. Direct Energy also provides energy efficiency and other home services products to residential customers through its Home Services divisions. Direct Energy has investments in renewable energy totaling approximately 443 MW of wind generation. www.directenergy.com

SILVER SPONSORS



www.bakerbotts.com



www.invenergyllc.com



www.gexaenergy.com



www.msmtx.com



www.morganlewis.com



www.siemens.com

STEAKLEY, WETSEL & CARMICHAEL, L.L.P.

<http://steakley-wetsel.lawoffice.com>



www.stoel.com



www.vestas.com



www.vinson-elkins.com

MOVIE AND DVD

Texas Wind Farms

A Tour from Turbines to Market

This short documentary—produced specifically for the 2007 Conference—takes you onto working wind farms in the Sweetwater, TX region: from ground operations to the top of the turbines, to explain construction, generation, operation, and interconnection. As a special bonus, each attendee will receive a complimentary DVD of the documentary.



REGISTRATION FOR WE07

Mail this registration form to:

The University of Texas School of Law, Attn. WE07

P.O. Box 7759, Austin, TX 78713-7759 or fax a copy to: (512) 475-6876

PLEASE PRINT CLEARLY

Bar Card# _____ TX Other State: _____ N/A

Name [Mr. / Ms.] _____

Firm _____

Address _____

City _____ State _____ Zip _____

Telephone _____ Fax _____

Registrant's Email (required) _____

Assistant's Email (optional) _____

Invoices, confirmations and receipts are emailed to these addresses.

REGISTRATION:

Registration includes Course Binder, Monday Reception, Tuesday Box Lunch Presentation, and Complimentary DVD (Texas Wind Farms)

- Early Registration Fee due by Wed., February 14, 2007 \$495.00
- Registration Fee after Wed., February 14, 2007 \$545.00
- State Employee Rate (\$375 after February 14, 2007) \$325.00

EXHIBITOR:

Exhibitor fee includes booth or table for two days. Please contact UTCLE at 512-475-6700 for set-up questions and information.

- Exhibitor fee (booth/table for two days)..... \$1000.00

CONFERENCE PUBLICATIONS AND MEDIA

Allow 2-4 weeks from the conference date for delivery.

- Course Binder with "Texas Wind Farms" DVD \$250.00
Note: Conference registration includes Course Binder.
- Audio CD Set \$175.00
- eBinder on CD (PDF format) \$200.00/\$50.00
(\$200 purchased alone, \$50 with registration or purchase of Course Binder or Audio CD Set)

IN-HOUSE CLE: Bring the conference in-house and learn at your convenience.

Allow 2-4 weeks from the conference date for delivery.

- In-House CLE for 2—Includes Audio CD Set and Course Binder \$750.00
_____ Add participants (includes Course Binder) for \$200 each \$ _____

TOTAL ENCLOSED \$ _____

METHOD OF PAYMENT

- Check (make checks payable to: The University of Texas at Austin)
- VISA or Mastercard (sorry, no AMEX or Discover)

Card # - - -

X _____ /
Authorized Signature Exp. Date (mm/yy)

AUSTIN

February 26-27, 2007
CONFERENCE LOCATION

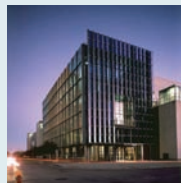

Austin Convention Center
500 E. Cesar Chavez Street
Austin, TX 78701
512-404-4000

Parking: Surface lot at Red River & Cesar Chavez, \$7 day
Garage parking at 2nd Street & Brazos, \$7 day

Nearby Accommodations:

Courtyard Marriott
300 E 4th St, Austin, TX 78701
512-236-8008
800-228-9290 (reservations)
Special Rate \$139
good through February 5, 2007
(subject to availability)

.....

KEY DATES

Registration & Cancellation

February 14, 2007—5 p.m.
last day for early registration
add \$50 for registrations
received after this time

February 16, 2007—5 p.m.
last day for full refund

February 19, 2007 —5 p.m.
last day for partial refunds
\$50 processing fee applied

February 26, 2007—9 a.m.
conference begins

CONFERENCE FACULTY

MIKE BERGEY
Bergey WindPower
Norman, OK

CHARLES L. BLACK
Wagstaff, Alvis, Stubbeman,
Seamster & Longacre, L.L.P.
Abilene, TX

DOUGLAS S. BLAND
Vinson & Elkins
Houston, TX

ANDY BOWMAN
Airtricity, Inc.
Austin, TX

KIMBERLEE CENTERA
AES Wind Generation
San Diego, CA

DR. JAMIE CHAPMAN
Texas Tech Wind Energy Center
Lubbock, TX

LISA CHAVARRIA-CO-CHAIR
McElroy, Sullivan & Miller, L.L.P.
Austin, TX

MATT CLOUSE
Green Power Partnership,
U.S. Environmental Protection
Agency (EPA)
Washington, DC

HON. MITCHELL G.
DAVENPORT
Jack County
Jacksboro, TX

KEN DONOHOO
ERCOT
Taylor, TX

MARK DREYFUS
Austin Energy
Austin, TX

SEAN FITZGERALD
GE Infra, Energy
Saratoga Springs, NY

SENATOR TROY FRASER
(Invited)
Texas Senate
Marble Falls, TX

MIKE GRABLE
ERCOT
Austin, TX

PAUL HASSINK
AEP
Tulsa, OK

CHRIS HENDRIX
Texas Retail Energy (Wal-Mart)
Bentonville, AR

DAVID HERRICK
FPL Energy, LLC
Juno Beach, FL

WILLIAM H. HOLMES
Stoel Rives LLP
Portland, OR

PAUL HUDSON
Public Utility Commission of
Texas (PUC)
Austin, TX

REPRESENTATIVE PHIL KING
State Representative
Weatherford, TX

STEPHEN KREBS
Baker Botts L.L.P.
Houston, TX

ANDY KRUSE
Southwest Windpower
Flagstaff, AZ

CHRIS A. LAMBERT
Mitsubishi Power Systems
Americas
Newport Beach, CA

WARD C. MARSHALL
Babcock & Brown
Austin, TX and San Francisco, CA

CRAIG MATAZYNSKI
RES Americas
Austin, TX

M. BRADFORD MOODY
Watt, Beckwith & Thompson,
L.L.P.
Houston, TX

PATRICK A. NYE
American Shoreline, Inc.
Corpus Christi, TX

CIARAN O'BRIEN
Airtricity, Inc.
Chicago, IL

PHILIP G. OLDHAM
Andrews Kurth LLP
Austin, TX

HEATHER OTTEN
Invenergy LLC
Austin, TX

C. KINGSBERY OTTO
Attorney
Austin, TX

JERRY PATTERSON
Texas General Land Office
Austin, TX

JORGE RAMIREZ
Texas General Land Office
Austin, TX

GEOFF SHARPLES
Clipper Windpower Inc.
Carpinteria, CA

ROBERT SIMS
AES Wind Generation
San Diego, CA

MIKE SLOAN-CO-CHAIR
Virtus Energy Research
Associates, Inc.
Austin, TX

KEVIN B. SMITH
Invenergy LLC
Chicago, IL

TOM "SMITTY" SMITH
Public Citizen
Austin, TX

DANY ST-PIERRE
Siemens Wind Power
Orlando, FL

BRENT G. STAHL
Stahl, Bernal & Davies, L.L.P.
Austin, TX

ANDREW SWIFT
Texas Tech Wind Energy
Center
Lubbock, TX

REPRESENTATIVE DAVID
SWINFORD
State Representative
Amarillo, TX

PHILLIP W. TONGE
Direct Energy, LP
Houston, TX

JESS TOTTEN
Public Utility Commission of
Texas (PUC)
Austin, TX

TJ TUSCAI
Gexa Energy
Houston, TX

ADAM S. UMANOFF
Morgan Lewis & Bockius LLP
Los Angeles, CA

WAYNE WALKER
Horizon Wind Energy
Houston, TX

RODERICK E. WETSEL
Steakley, Wetzel &
Carmichael, L.L.P.
Sweetwater, TX

KATHLEEN HARNETT WHITE
Texas Commission on
Environmental Quality (TCEQ)
Austin, TX

STEPHEN WIELAND
Vestas Americas
Denver, CO

STEPHEN WILEY
Gamesa Energy USA
Austin, TX

PHIL WILSON
Office of the Governor
Austin, TX

DAN WOODFIN
ERCOT
Taylor, TX

ROBERT P. WRIGHT
Baker Botts L.L.P.
Houston, TX

ABOUT THE COVER

Cover photo by Joanna
Jefferson. For more
information, please email
jjefferson@law.utexas.edu

UTCLE

THE UNIVERSITY OF TEXAS AT AUSTIN
THE UNIVERSITY OF TEXAS SCHOOL OF LAW
P.O. Box 7759 • Austin, TX 78713-7759

This program is not printed or mailed at state expense.

M
C
L
E

This course has been approved for Minimum Continuing Legal Education credit by the State Bar of Texas Committee on MCLE in the amount of 13.25 hours. The University of Texas School of Law is a State Bar of California approved MCLE provider (sponsor #1944).

2007

WIND ENERGY INSTITUTE

February 26-27, 2007 • Austin Convention Center • Austin, TX

NON-PROFIT-ORG
U.S. Postage Paid
The University of Texas
School of Law

E-mail us at
utcle@law.utexas.edu
or call us at
512-475-6700
for more information